

PROV2-LK Strike Optic Upgrade Kit Installation Guide

Fixture: PROV - Providence Medium



WARNING: Fixtures must be grounded in accordance with local codes or the National Electrical Code. Failure to do so may result in serious personal injury.

MAINTENANCE: A regularly scheduled maintenance program should be established to retain optimum light output and reduce heat retention. Dusting with a soft, clean, dry cloth is normally sufficient for the optics.

CAUTION: All wiring must be done by a qualified electrician. KEEP THIS SHEET FOR FUTURE REFERENCE.

PACKAGE CONTENTS:

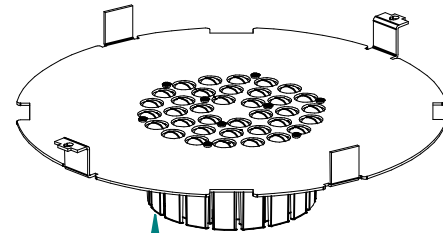
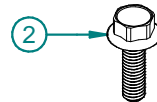
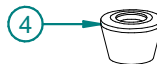
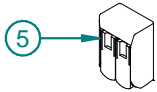
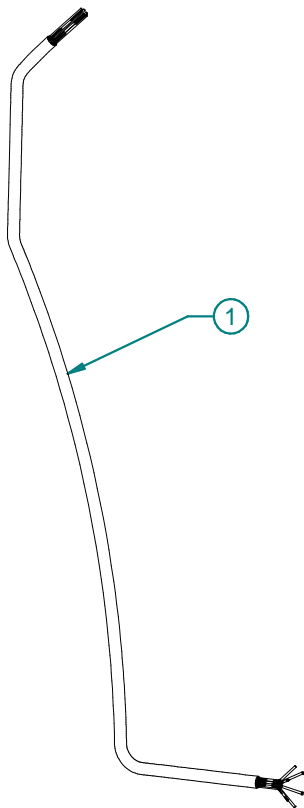

LED ASSEMBLY

DRIVER ASSEMBLY

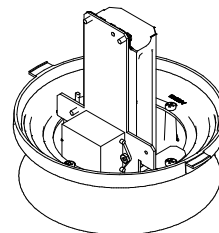

INDIRECT
VERSION

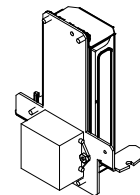

HID/LED
VERSION

10	1		OPTIC ASSEMBLY	
9	1		DRIVER ASSEMBLY	
8	1	93139649	INSTALLATION INSTRUCTIONS PROV2-LK	
7	3	88033	CABLE TIE 4in HEAT STABILIZED	(NOT SHOWN)
6	2	A80120	CLIP-FTR CAP BTTM-PROV	
5	3	0874070B	CONN-WAGO 2-WIRE 221-412	
4	2	93007210	CORD SEAL SILICONE	
3	2	A84281	WSHR 1/4 SPLIT LCK SS	
2	2	23117829901	SCR 10-24x.75 HXDHWMS STL ZN	
1	1	93007211-24	CBL-5 CNDCTR - 24in LONG	
ITEM #	QTY	PART #	DESCRIPTION	NOTES

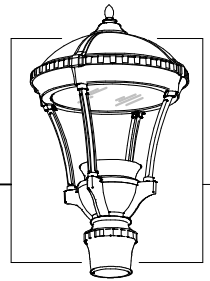

PROV2-LK Strike Optic Upgrade Kit Installation Guide

Fixture: PROV - Providence Medium

1. PREPARE TOP DOME

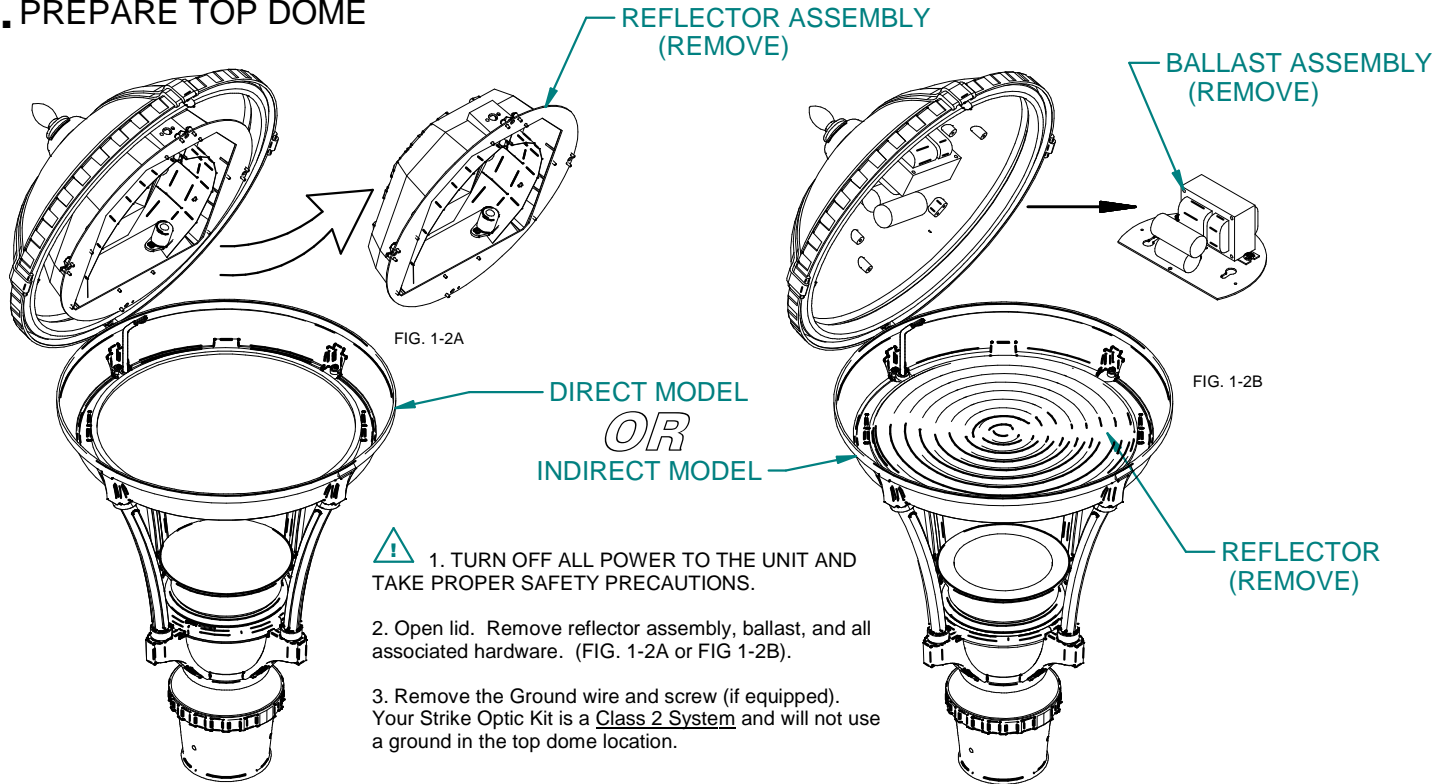

2.

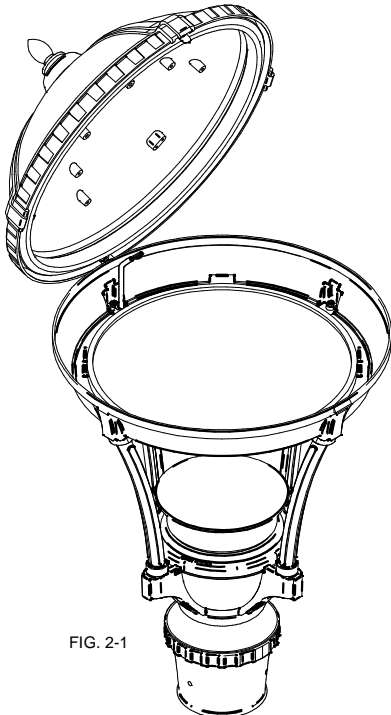

The entire top dome should now be completely clear of all sheet metal and hardware.

3. LENS REMOVAL *or* INSTALLATION (OPTIONAL):

The fixture can be used with or without lens.

If installing lens, be sure the ridge on the gasket is on the bottom.

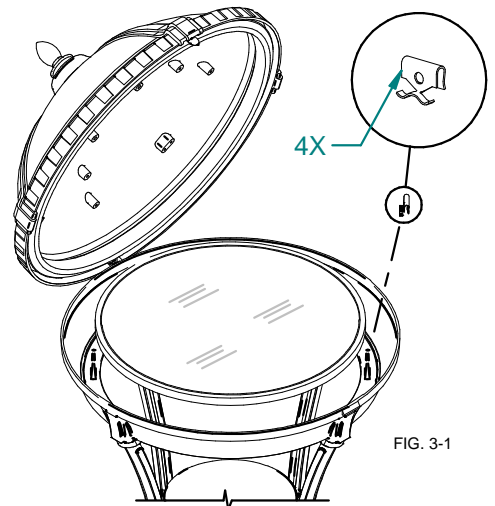
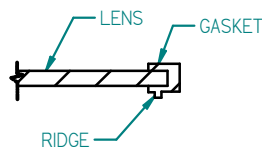

To remove existing lens:

1. Using Vice-Grips, pull off three (3) of the four (4) lens clips.
2. Remove lens and gasket.
3. The fourth lens clip will then come off very easily.

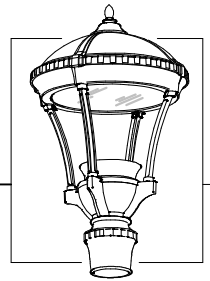

PROV2-LK Strike Optic Upgrade Kit Installation Guide

Fixture: PROV - Providence Medium

4. PREPARE DRIVER ASSEMBLY

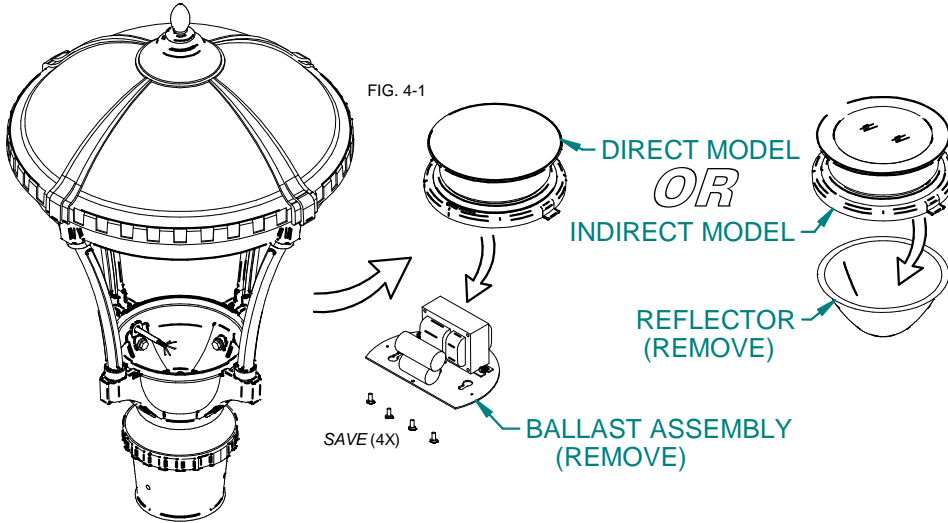
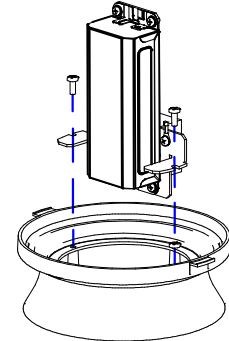
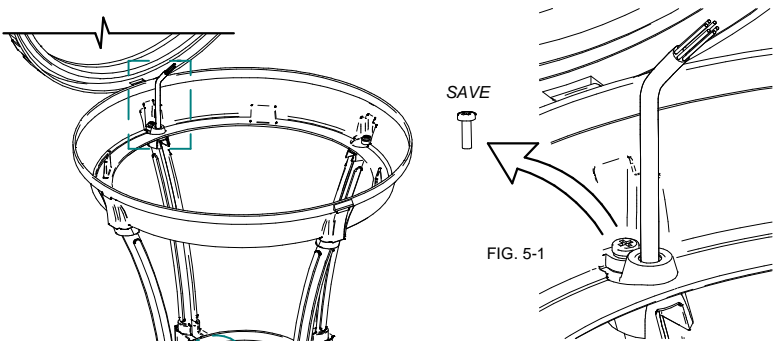

FIG. 4-5



1. Remove Lower Slipfitter Cap by rotating it counter-clockwise.
 2. Remove ballast assembly (applications vary). Remove ground wire and screw.
 3. SAVE the four (4) 10-24 x 3/8" screws, they will be reused.
 4. Install LED Driver Assembly into slipfitter cap using existing screws from Step 3.
- (Driver assembly can be assembled into round slipfitter cap in any 90° orientation.)

5. RETROFIT 5-CONDUCTOR CABLE



1. Locate the strut that contains the power cable. Remove and SAVE the 10-24 x 1/2" screw that secures the strut. (FIG. 5-1)
2. In the bottom section, remove and SAVE the 1/4-20 x 3/4" screw and washer. (FIG. 5-2)

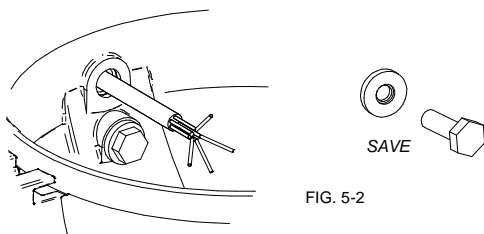

FIG. 5-2

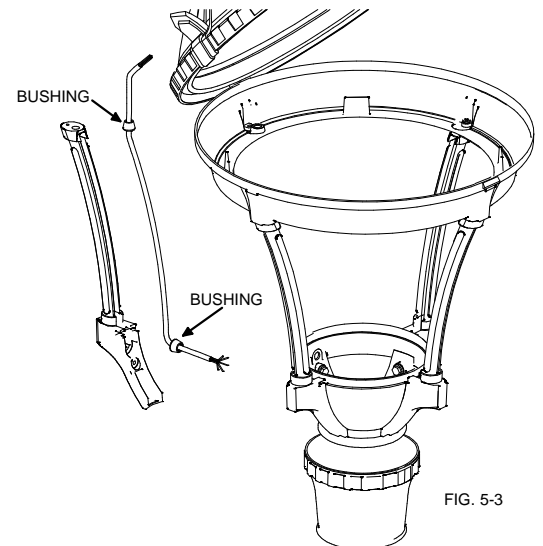
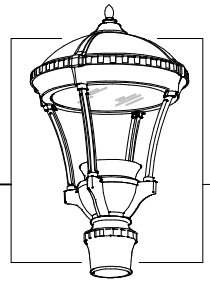

FIG. 5-3

3. Replace existing power cable and grey silicone bushings with new 5-conductor cable and orange bushings.
4. Re-assembly of the strut is the opposite of dis-assembly.



PROV2-LK Strike Optic Upgrade Kit Installation Guide

Fixture: PROV - Providence Medium

6. DRIVER ASSEMBLY WIRING

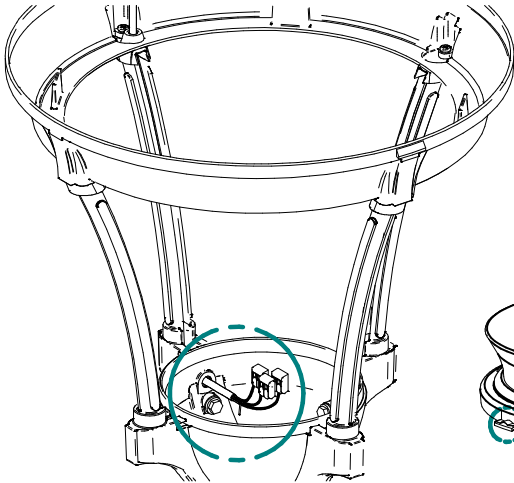

FIG. 6-1

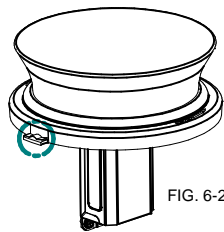

FIG. 6-2

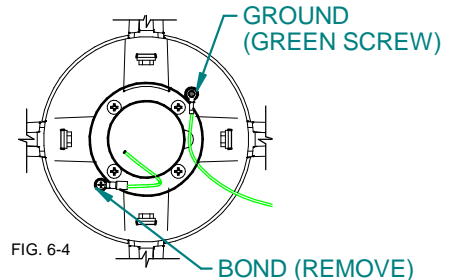
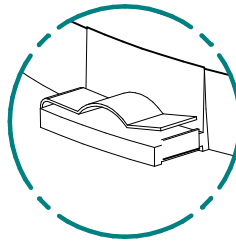

FIG. 6-4

1. Connect the provided waggo connectors to the power cable, use Brown, Blue and Black wires (see FIG 6-1). Cap off green/yellow and gray wires, these will not be used.
2. Install clips into the Slipfitter cap tabs per FIG 6-2. Do not place backwards.
3. Connect the driver wires to the waggo connectors following the FIG 6-3 wiring diagram.
4. See FIG 6-4. Connect grounding eyelet to existing ground screw in lower fixture casting area. The bonding screw & wire can be removed. (If existing, applications vary).

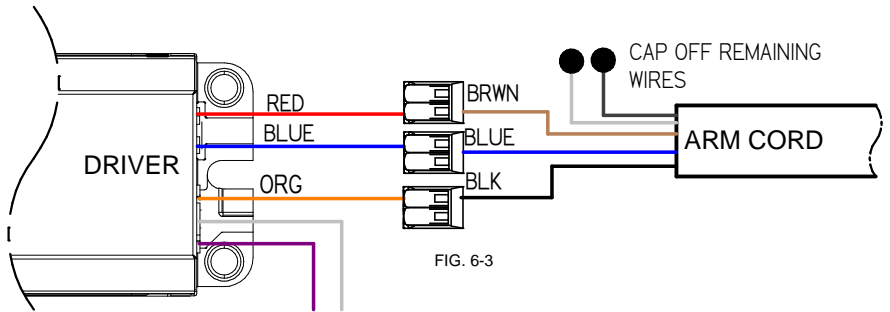
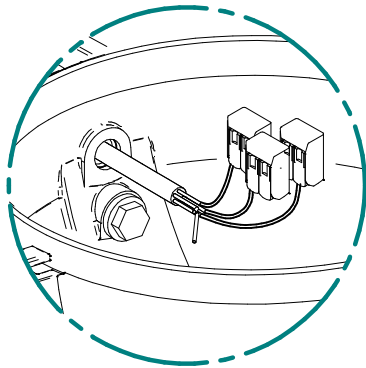

FIG. 6-3

7. LIGHT ENGINE ASSEMBLY WIRING

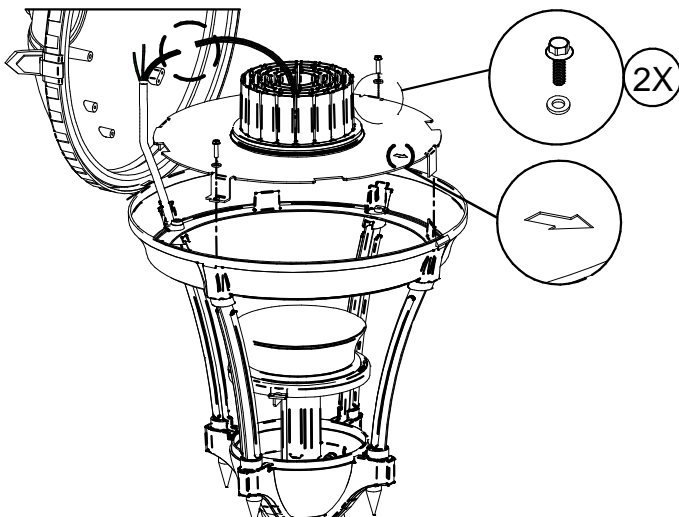

FIG. 7-1

1. Remove and discard the two (2X) strut screws that are located 90° from hinge location.
2. Note orientation of light pattern arrow. Arrow typically points towards street-side, away from dome hinge.
3. Install Light Engine assembly using (2X) supplied 10-24 x .75" screws (FIG 7-1).
4. Connect power cord to LED wires as shown at PG.5. Wiring may vary depending the Lumen output option.
5. Connect power quick connector to existing incoming connector. Place and turn clockwise lower slipfitter cap into place. Follow FIG 7-2 to ensure cap is secured.
6. Lower lid, power fixture - UPGRADE COMPLETE.

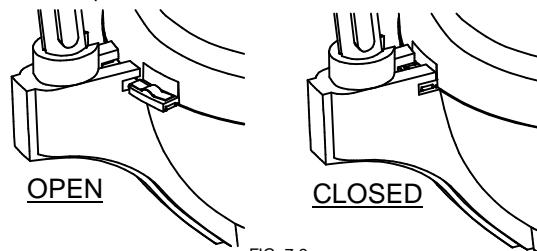
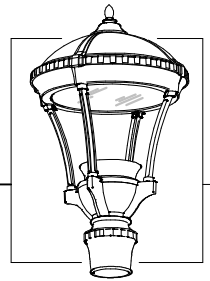

FIG. 7-2



PROV2-LK Strike Optic Upgrade Kit Installation Guide

Fixture: PROV - Providence Medium

WIRING DIAGRAM

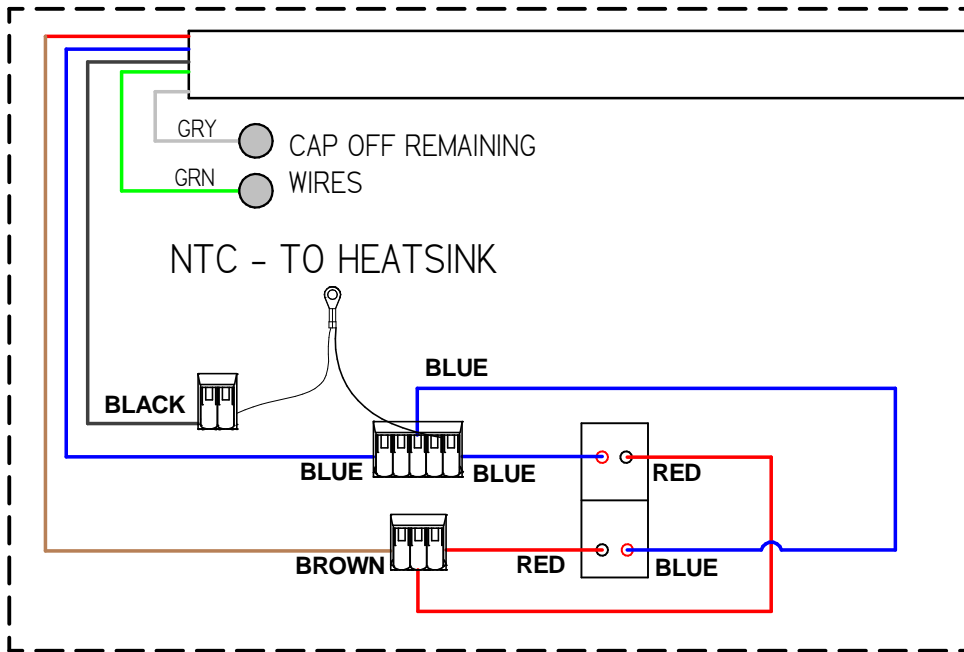

295 AND 325mA WIRING DIAGRAM

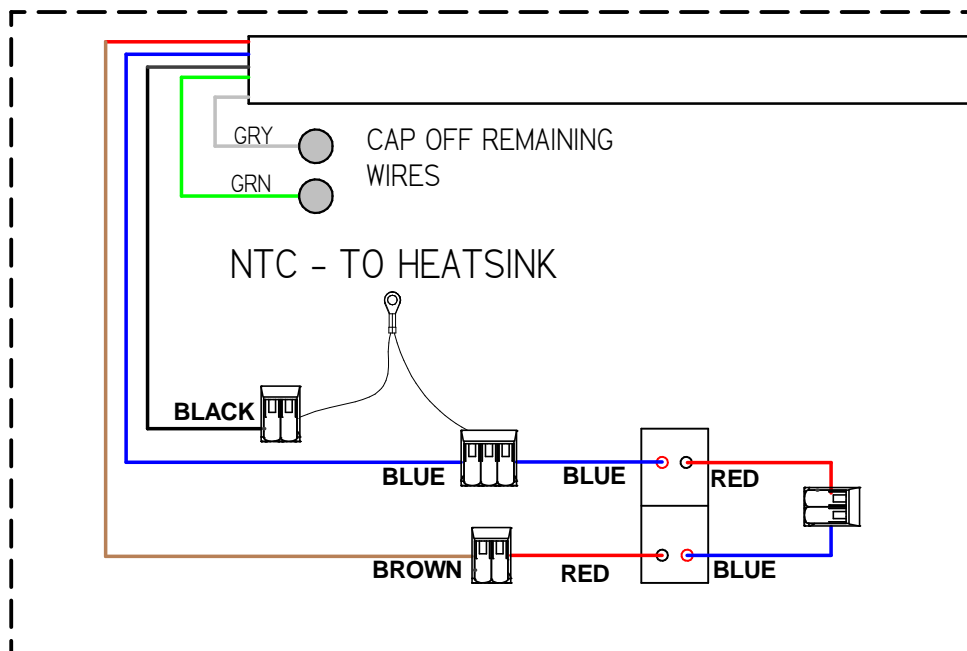

510, 525mA AND 615mA WIRING DIAGRAM